

## Olympus Pearlborder T1000 Transcriber Instructions

PearlCorder

T1000  
MICROCASSETTE TRANSDUCER

TAPE COUNTER

000

EJECT

SPEED

TOPE

VOLUME

OLYMPUS OPTICAL CO., LTD.

REW

POWER

LISTEN

FF

STOP

STOP



## CONTENTS

INTRODUCTION .....	4	3. Operation with the Hand Controller .....	5
DESCRIPTION OF CONTROLS .....	4		
<b>A. DICTATION</b>		<b>C. OTHER FUNCTIONS</b>	
1. Preparation .....	4	1. Quick Erase .....	6
2. Dictation and Conference Recording .....	5	2. Audible Warning .....	6
3. Telephone Conversation Recording .....	5	3. Prevention of Accidental Erasure .....	6
		4. Care in Handling .....	6
<b>B. TRANSCRIPTION</b>		5. Helpful Hints .....	6
1. Operation of Main Unit .....	5	6. Maintenance .....	6
2. Operation with the Foot Switch .....	5	7. Main Specifications .....	6

## INHALT

DANKE .....	7	3. Einsatz mit Handmikrofon .....	9
BESCHREIBUNG DER BEDIENTUNGSELEMENTE .....	7		
<b>A. EINSATZ ALS DIKTIERGERÄT</b>		<b>C. SONSTIGES</b>	
1. Vor Inbetriebnahme .....	7	1. Schnelllöschung .....	9
2. Diktat- und Konferenzaufnahme .....	8	2. Akustische Signale .....	9
3. Aufzeichnung von Telefongesprächen .....	8	3. Schutz gegen versehentliches Löschen .....	9
		4. Hinweise .....	9
<b>B. EINSATZ ALS WIEDERGABEBERÄT</b>		5. Fehlersuche .....	9
1. Inbetriebnahme .....	8	6. Wartung .....	9
2. Einsatz mit Fußschalter .....	8	7. Technische Daten .....	9

## SOMMAIRE

INTRODUCTION .....	10	3. Utilisation de la télécommande manuelle .....	11
DESCRIPTION DES COMMANDES .....	10		
<b>A. FONCTION DICTAPHONE</b>		<b>C. AUTRES FONCTIONS</b>	
1. Préparation pour l'enregistrement .....	10	1. Effacement rapide .....	12
2. Enregistrement dictée et en salle de conférence .....	11	2. Signaux sonores d'avertissement .....	12
3. Enregistrement de conversation téléphonique .....	11	3. Prévention de l'effacement accidentel .....	12
		4. Précautions .....	12
<b>B. MODE TRANSCRIPTEUR</b>		5. Conseils utiles .....	12
1. Utilisation de l'appareil .....	11	6. Maintenance .....	12
2. Utilisation de la commande au pied .....	11	7. Caractéristiques principales .....	12

## CONTENIDO

INTRODUCCIÓN .....	13	3. Operaciones con el controlador manual .....	15
DESCRIPCIÓN DE LOS CONTROLES .....	13		
<b>A. COMO DICTAR</b>		<b>C. VARIOS</b>	
1. Preparativos para dictar .....	13	1. Borrado rápido .....	15
2. Grabación de dictados y conferencias .....	14	2. Pitidos de advertencia .....	15
3. Grabación de conversaciones telefónicas .....	14	3. Prevención del borrado accidental .....	15
		4. Cuidado en el manejo .....	15
<b>B. USO DEL TRANSCRIPTOR</b>		5. Consejos prácticos .....	15
1. Operaciones con la unidad principal .....	14	6. Mantenimiento .....	15
2. Operaciones con el interruptor de pedal .....	14	7. Características principales .....	16

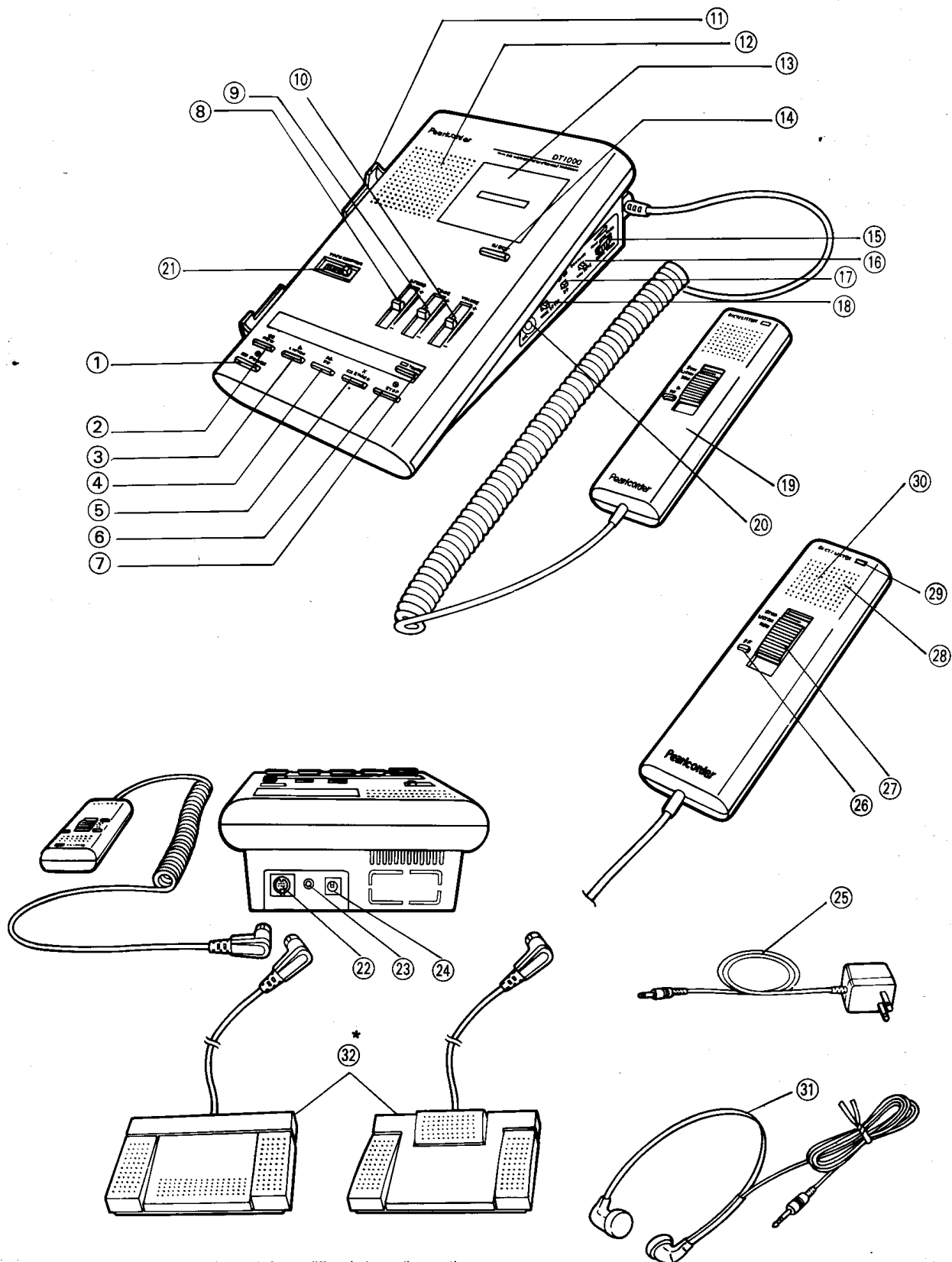

- \* Standard models of foot switch are different depending on the area.  
Please check the suitable foot switch for your country.
- \* Je nach Gebiet werden Fußschalter in unterschiedlichen Ausführungen  
geliefert. Wählen Sie bitte den Fußschalter, der für Ihr Gebiet geeignet ist.
- \* Le modèle standard de pédale varie selon le pays où vous vous trouvez.  
Vérifiez la bonne compatibilité de votre pédale.
- \* Dependiendo de las áreas, los modelos estándar de interruptor de pedal  
difieren. Confirme el interruptor de pedal de su área.

**INTRODUCTION**

Thank you for choosing the Olympus Pearlcorde. Please read these instructions carefully and check the package label to confirm that all standard accessories are included.

Standard accessories include AC adaptor.

**DESCRIPTION OF CONTROLS**

- |                                 |  |
|---------------------------------|--|
| ① POWER Button/LED              | ⑱ TAPE SPEED Switch                                    |
| ② REW Button                    | ⑲ Hand Controller (DT1000 only)                        |
| ③ LISTEN Button                 | ⑳ HEADSET Jack   |
| ④ Fast Forward Button           | ㉑ Tape Counter   |
| ⑤ ERASE Button/LED              | ㉒ FOOT SW/HAND MIC Jack (DT1000 only)                  |
| ⑥ STOP Button                   | ㉓ TEL REC Jack (DT1000 only)                           |
| ⑦ TEL REC Button (DT1000 only)  | ㉔ DC 9V Jack   |
| ⑧ SPEED Control Knob            | ㉕ AC Adaptor   |
| ⑨ TONE Control Knob             | ㉖ FF Button  |
| ⑩ VOLUME Control Knob           | ㉗ Dictation Control Selector<br>[DICT/STOP/LISTEN/REW] |
| ⑪ Hand Controller Rack          | ㉘ Monitor Speaker                                      |
| ⑫ Built-in Speaker              | ㉙ Red/Green LED Indicator                              |
| ⑬ Microcassette Compartment     | ㉚ Built-in Microphone                                  |
| ⑭ EJECT Button                  | ㉛ Headset  |
| ⑮ BACK SPACE Controller         | ㉜ Foot Switch  |
| ⑯ MIC SENS Switch (DT1000 only) |  |
| ⑰ Speaker Selection Switch      |  |

**A. DICTATION (DT1000 only)****1. Preparation**

1. Plug the AC adaptor ⑳ into an AC outlet, and connect the AC adaptor cord to the DC 9V jack of the main unit ㉔.
2. Insert the plug for the Hand Controller ⑲ into the HAND MIC jack at the rear of the main unit ㉒.
3. Press the POWER button ① to turn the unit ON.
4. Press the EJECT button ⑭ to open the Microcassette compartment ⑬. Insert a Microcassette by sliding it into the holder with the open side of the cassette facing out. Gently press the cassette compartment down until it locks.
5. Dictation functions can be implemented with the Hand Controller ⑲. The Hand Controller takes priority over the buttons and switches on the main unit (except the POWER and TEL REC buttons). Should you wish to use the buttons on the main unit only, move the Dictation Control Selector ㉗ to the 'STOP' position, or disconnect the Hand Controller.

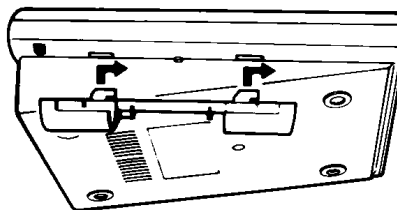
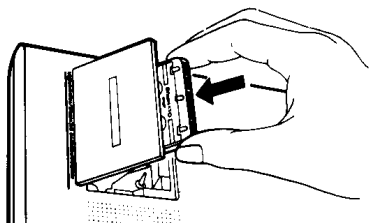
**Please Note:**

- a) Press the POWER button ① to turn the unit OFF, when the main unit is not in use.
- b) Attach the Hand Controller Rack ⑪ to either the right or left side of the unit whichever is most convenient to you.

To place the rack on the left side of the unit, insert it into the holes and slide it toward you. To place the rack on the right side, insert it into the holes and slide it away from you.

## 2. Dictation and Conference Recording

1. Set the tape speed (2.4 cm/sec. or 1.2 cm/sec.) utilizing the TAPE SPEED switch (18).
2. Set the MIC SENS switch (16) on the main unit to the 'DICT' position.
3. Move the Dictation Control Selector (27) on Hand Controller (19) to the 'DICT' position. The red LED (29) will illuminate.
4. Pick up and hold the Hand Controller approximately 5 to 8 cm (2 to 3 in.) from your mouth and talk in a

normal voice.

5. For conference recording, set the MIC SENS switch (16) on the main unit to the 'CONF' position and place the Hand Controller in the center of the table.
6. When dictation has ceased, move the Dictation Control Selector (27) to the 'STOP' position. The red LED will go out.
7. Press the EJECT button (14) to remove the tape.

### Please Note:

- a) While the Dictation Control Selector (27) is in the 'LISTEN' position, depress the FF button (26) to quickly advance the tape.
- b) To rewind the tape, move the Dictation Control

Selector (27) to the 'REW' position and keep holding the switch. Releasing it returns it to the 'LISTEN' position.

## 3. Telephone Conversation Recording

1. Insert the plug from the telephone pick-up (TP-6) into the TEL REC jack (23) of the main unit.  
For details, refer to the TP-6 instruction manual.
2. Press the TEL REC button (7) twice within 1 second.

The red LED will light and start recording the conversation through the telephone.

3. When the recording is completed, press the TEL REC button (7) again.

### Please Note:

- a) The TEL REC takes priority over any other mode.
- b) The recording can be monitored via the built-in speaker (12) or through the Headset (31). Adjust the volume by sliding the VOLUME knob (10).

- c) When the volume is too high, it sometimes causes howling. In such case, adjust the volume with the VOLUME Control Knob.

## B. TRANSCRIPTION

### 1. Operation of Main Unit

1. Plug the AC adaptor (25) into an AC outlet, and connect the AC adaptor cord to the DC 9V jack of the main unit (24).
2. Press the POWER button (1) to turn the unit ON.
3. Set the Speaker Selection Switch (17) to the 'ON' position.
4. When using the Headset (31), set it at the 'OFF' position.
5. Press the EJECT button (14), insert the recorded microcassette and gently close the microcassette compartment (13).

6. Set the tape speed (2.4 cm/sec. or 1.2 cm/sec.) with TAPE SPEED switch (18).
7. Set the SPEED control knob (8) at the center position for standard speed. With this knob, fine adjustment of the tape speed within the range between -15% and +30% is possible.
8. Adjust the TONE to your preference (9).
9. Adjust the VOLUME to a suitable level (10).
10. Rewind the tape by pressing REW button (2).
11. Press the LISTEN button (3) to play back the tape.

### 2. Operation with the Foot Switch

1. Connect the plug of the Foot Switch (32) to the FOOT SW jack (22) on the main unit.
2. The rewind time for the tape can be adjusted for 0 to 1 second by using the Back Space Controller (15) on the main unit. Every time the tape stops, the auto back space function operates. When using the Foot Switch to change the mode from 'LISTEN' to

'STOP'; the tape backspaces between 0 and 1 second of listening time. If back space is not required, set the knob to '0'.

3. Press the LISTEN pedal to start the tape.
4. Pressing the FF or REW pedal fast forwards or rewinds the tape.

### Please Note:

The 'LISTEN' mode remains when both the LISTEN and FF or REW pedals are depressed simultaneously.

### 3. Operation with the Hand Controller

1. Follow procedures 1 to 10 in the operating instructions for the main unit.
2. Set the Speaker Selection Switch (17) to the 'OFF' position. The speaker of the Hand Controller is then activated.
3. Move the Dictation Control Selector (27) to the 'LISTEN' position. The green LED (29) will light.

4. To rewind the tape, move the Dictation Control Selector (27) to the 'REW' position and keep holding the switch. Releasing the Selection Switch returns it to the 'LISTEN' position.
5. During pressing the FF button (26) changes to fast forward mode.

## C. OTHER FUNCTIONS

### 1. Quick Erase

While the ERASE button ⑤ is pressed, pressing the Fast Forward ④ or REW ② button activates quick erase.

When the tape reaches the end, the tape stops automatically.

### 2. Audible Warning

A warning beep sounds in the following situations:

1. When trying to operate the main unit without a tape inserted.
2. When the tape comes to the end.

3. When trying to perform quick erase on a tape with the safety lugs removed.

4. When trying to record on a tape with the safety lugs removed. (DT1000 only)

### 3. Prevention of Accidental Erasure

1. To avoid accidental erasure, break and remove the safety lug on the Microcassette by pushing it inward with a ball-point pen or any other hard pointed object.
2. Without the lug, the ERASE button ⑤ cannot be activated.
3. If you wish to record on a microcassette with the safety lug removed, cover the hole with plastic tape.

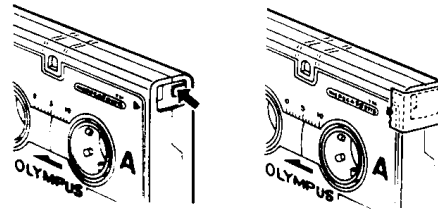

### 4. Care in Handling

1. Avoid exposing the unit, Hand Controller and any other accessories to direct sunshine, high temperatures, high humidity or strong magnetic fields.

2. To clean the unit, Hand Controller and any other accessories, do not use solvent such as benzene or thinner.

### 5. Helpful Hints

Q1. The tape does not run.

A1. Is the AC adaptor connected properly?

Is the POWER button pressed ON?

Q2. The unit (or Hand Controller) produces no sound.

A2. Check the VOLUME level.

Check to see if the Headset is plugged in.

Check whether the Speaker Selector Switch is in the OFF position or not.

Q3. Sound level is unstable or low.

A3. The head and/or pinch roller may be dirty.

### 6. Maintenance

1. Keep the head clean at all times. If necessary, apply head cleaning solvent with a swab.
2. Excessive tape slack can cause malfunctions. Lightly

insert a pencil into the core of the reel and turn gently until the slack is removed.

### 7. Main Specifications

Tape: Microcassette

Tape Speed: 2.4 cm/sec. & 1.2 cm/sec. adjustable -15% to +30%

Speaker: 57 mm dynamic speaker

Power Source: DC 9V 800mA (AC Adaptor)

Frequency Response: 250~4,000 Hz at 2.4 cm/sec.

Practical Max. Output: 250 mW (2.4 cm/sec.)

Dimensions & Weight: 170 (W) × 240 (L) × 78 (H) mm (6.7 × 9.5 × 3.1 in.) 0.8 kg (1.8 lb.)